

INTERNAL ASSESSMENT
ESTIMATING & COSTING
2nd Year CE, F.M- 20

Q1. Find out the quantity of the following item of works as per fig.1

- a) Brick work in foundation and plinth.
- b) Brick work in superstructure.
- c) Cement concrete (1:1.5:3) in roof slab.
- d) Plaster work in inside and out wall.
- e) Artificial stone flooring.

Total centre line is to be calculated in the following way:

$$TCL = (CL \text{ calculated from the fig.} + R)$$

[R is the last digit of your roll no.]

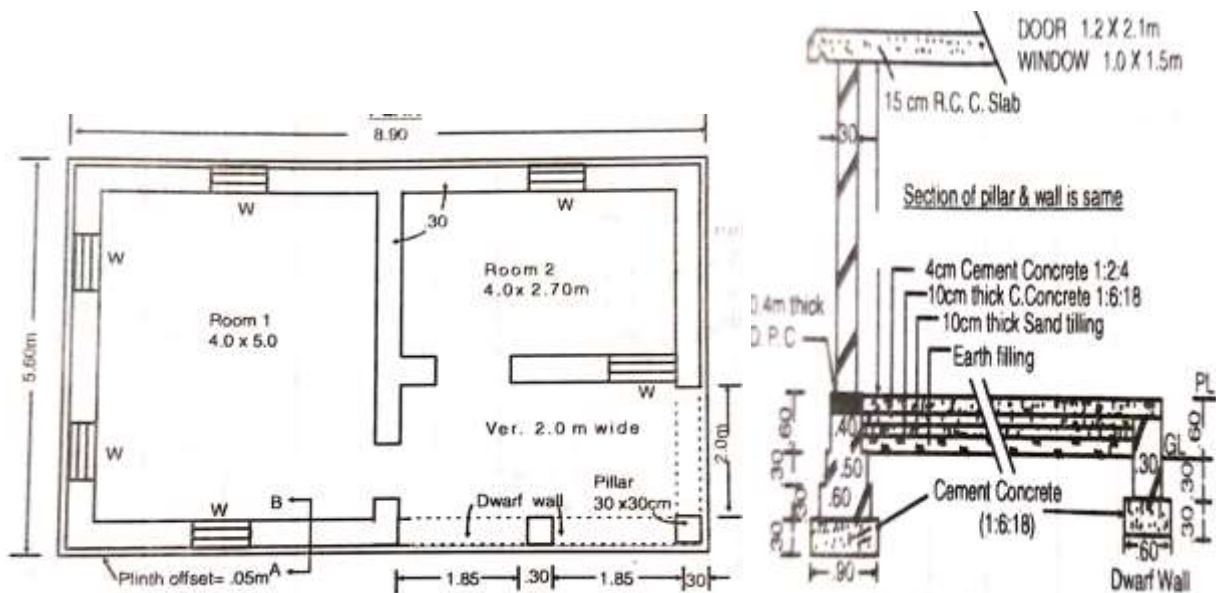

Fig.1

The answer script should be sent in the following email Id along with the signature of the student in all pages.

email Id: civilhodjcgp2020@gmail.com Last date of submission: 12.08.2020

The original copy is to be submitted only when the Institution is open.

Sd/-
(Dr.Saibal Chakraborty)
Head, Civil Engineering Dept.